

## 22 CHAPEL STREET | 1 RUMFORD PLACE | LIVERPOOL

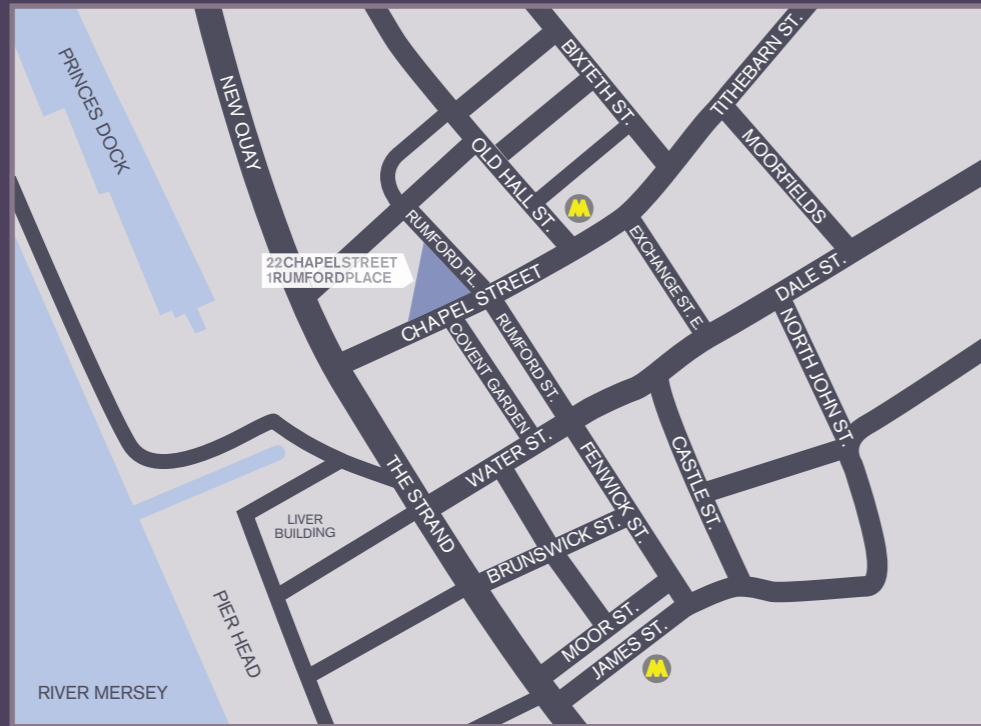

FOR MORE INFORMATION



Contact: John Barker

The information contained within this brochure is for guidance only. These particulars should not be relied upon as accurately describing any of the specific matters described by an order under the Property Misdescription Act 1991. Intending purchasers should satisfy themselves by inspection or otherwise as to correctness of each item. All items are correct as above at time of print (02/07).

# RETAIL SPACE

**TO LET** 1,436 SQ FT - 6,060 SQ FT OF PRESTIGIOUS RETAIL & LEISURE SPACE IN LIVERPOOL'S CENTRAL BUSINESS DISTRICT.



22 CHAPEL STREET | 1 RUMFORD PLACE | LIVERPOOL

## 22 CHAPEL STREET | 1 RUMFORD PLACE

offer you outstanding retail opportunities located at the street level of Liverpool's smartest new office building, 20 Chapel Street, and adjacent to Unity, the city's coolest residential tower at Rumford Place.

They are within walking distance of Liverpool's famous waterfront - a recognised world heritage site - and are in sight of the Royal Liver Building.

Right in the heart of the central business district the area is bustling with young professionals, cool bars, stylish restaurants, shops and boutique hotels as well as a rapidly growing number of residential developments.

The area is already home to distinguished names such as The Raquet Club, Malmaison, Radisson SAS and Crowne Plaza to name but a few.

Transport links to Chapel Street are excellent with Moorfields and James Street Stations a short stroll away.



### TO LET

Three units ranging from 1,436 sq ft to 6,060 sq ft, with planning consent for A1, A2 & A3 uses.

### GROUND FLOOR

- Chapel Street total floor area 429.6 sq m 4624 sq ft
- Rumford Place floor area 133.4 sq m 1436 sq ft

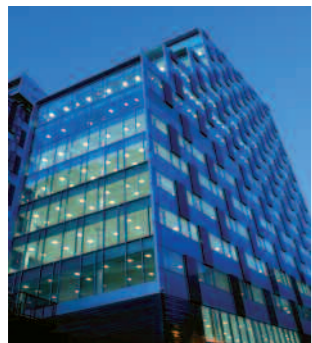
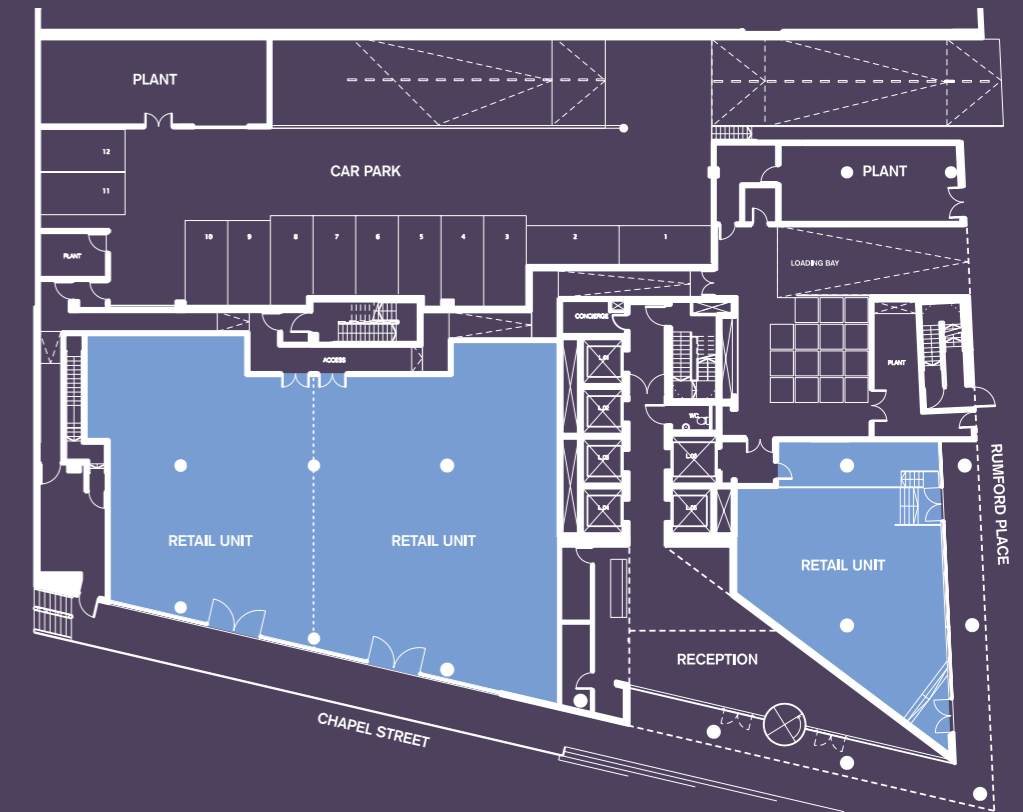

FOR MORE INFORMATION

**Hitchcock Wright & Partners**  
 CHARTERED SURVEYORS  
**0151 227 3400**

Contact: John Barker